



EMILYCube 2500

Off-grid power source for electrical devices in the field

-  Increased sustainability
-  No detectable signature
-  Plug & Play solution



Solutions, features and references

To equip military operations and command posts, task forces require a reliable and self-sufficient power source. EMILY Cube ensures this. With a 100 Watt fuel cell, an integrated lithium ion battery and a 10 l fuel cartridge in a ruggedised housing, this total solution, weighing only 20 kg, can be used immediately anywhere.

From a logistical point of view, transporting fuel cartridges of only 8.4 kg is much more efficient compared with batteries and diesel fuel required for generators.

At a continuous power requirement of 100 W, EMILYCube reliably delivers more than 100 hours of power without user intervention.

After those 100 hours, only the fuel cartridge has to be replaced, so the same self-sufficiency is available again. Replacing the fuel cartridge takes only a few seconds and can take place whilst the system is running ("hot swap").

With a partial load of e.g. 25 W, the self-sufficiency increases almost in direct proportion to 400 hours with a fuel cartridge of 10 litres.

Combining the high energy density of the methanol fuel and the EMILY Cube technology, the use has a long duration silent power source compared with batteries or generators. Furthermore, EMILYCube generates power without detectable signatures,

Application

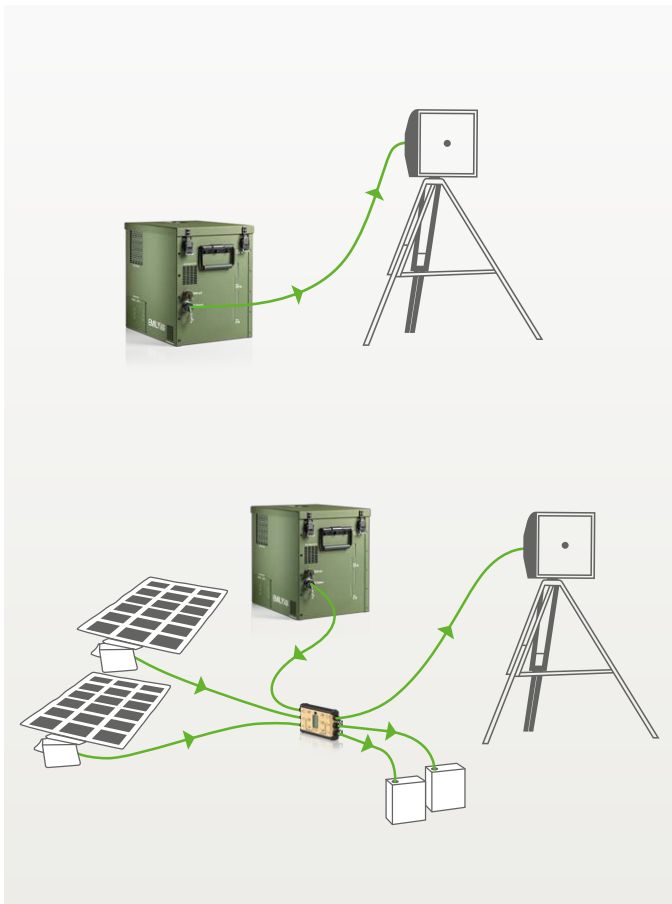

Overview

- Virtually silent operation compared to conventional generators
- "Stand-alone" and "plug & play" energy solution for immediate use
- Ideal power source for off-grid operations, field-based charging stations, radio relay stations, mobile ground radar and much more
- Combined with the SFC Power Manager 3G, additional power generators and energy sources can be connected, as well as supplying several loads with power at the same time.
- Portable and robust with many uses
- Easy operation
- 100 Watts for more than 100 hours with only one fuel cartridge
- EMILYCube has been used by US Commands since 2012.
- The fuel cartridges are approved for air transport in accordance with UN3473.



Technical data

Charging performance per day*	2500 Wh
Nominal power	100 W
Peak load	Up to 150 W for 2 minutes
Nominal voltage	12.4 V - 30 V
Weight	13.3 kg without fuel cartridge 21.7 kg with an M10 fuel cartridge
Dimensions L x W x H	418 x 305 x 384 mm
Energy storage*	11.1 kWh (1 x M10 fuel cartridge)
Operating temperature	-25 °C to +50 °C
Warranty	2 years/3000 operating hours
Military ruggedisation & electromagnetic compatibility	MIL-STD 810 and MIL-STD 461

*All technical data under test conditions of 20 °C / 68 °F.

Weight reduction

Energy contents of the fuel cartridge compared with 80 Ah lead batteries

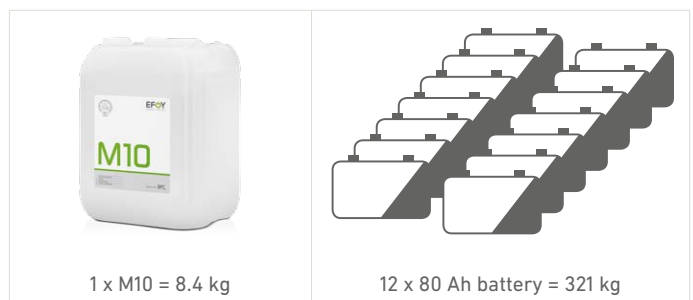

Germany

SFC Energy AG (HQ)
Eugen-Saenger-Ring 7
85649 Brunnthal
Germany

T +49 89 673 592-0
F +49 89 673 592-369
M info@sfc.com
W www.sfc-defense.com

